

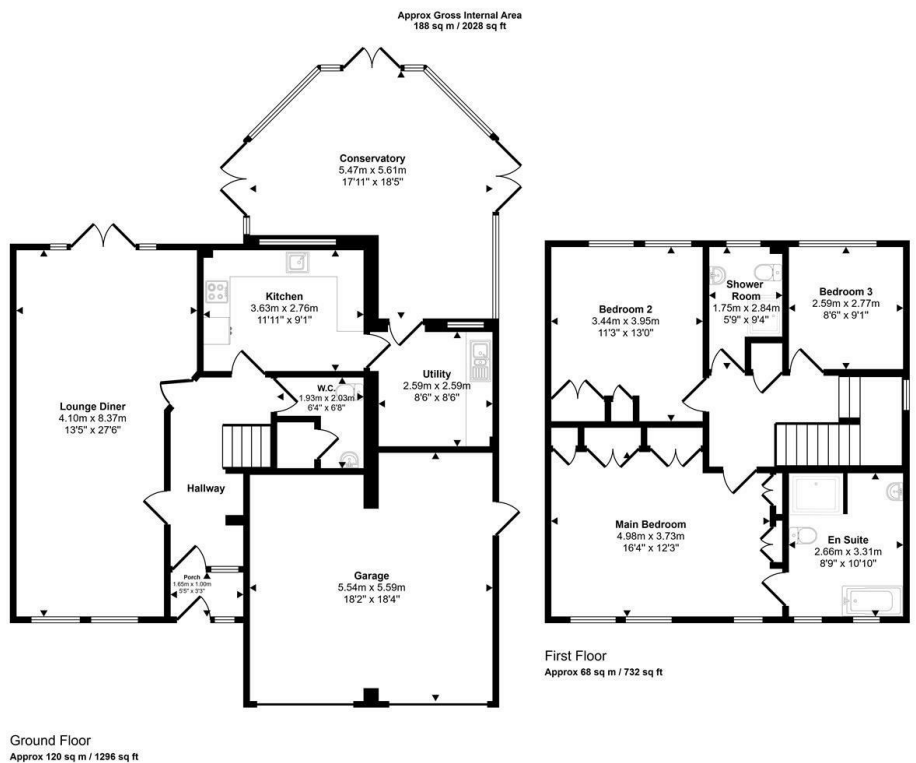

2 Rawlins Close, Finchley, London, N3 3TA

Asking Price £1,200,000

- Freehold Detached House
- Two Bathrooms and a Cloakroom WC
- Front & Rear Garden
- Three Bedrooms
- Double Garage to Side
- Vacant Possession
- Close to Finchley Central and Mill Hill East Underground Stations (Northern Line)
- Off-Street Parking for multiple vehicles on Forecourt



This floorplan is only for illustrative purposes and is not to scale. Measurements of rooms, doors, windows, and any items are approximate and no responsibility is taken for any error, omission or mis-statement. Icons of items such as bathroom suites are representations only and may not look like the real items. Made with Made Snappy 360.

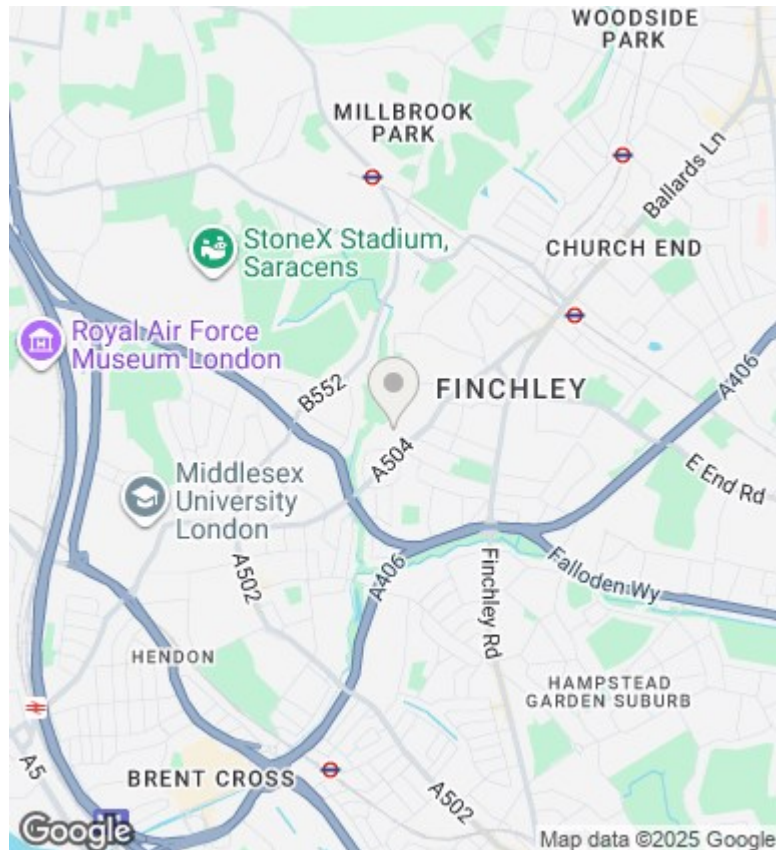

Viewings

Viewings by arrangement only. Call 020 7485 0112 to make an appointment.

Council Tax Band

C

EPC Rating:

C

| Energy Efficiency Rating | | Current | Potential |
|--|---|-------------------------|-----------|
| <i>Very energy efficient - lower running costs</i> | | | |
| (92 plus) | A | | |
| (81-91) | B | | |
| (69-80) | C | 71 | 80 |
| (55-68) | D | | |
| (39-54) | E | | |
| (21-38) | F | | |
| (1-20) | G | | |
| <i>Not energy efficient - higher running costs</i> | | | |
| England & Wales | | EU Directive 2002/91/EC | |